



PARTS & MERCHANDISE  
STORE

Case IH Max Service  
NACustomerRelations@caseih.com  
877-422-7344 Option 1

621 State Street  
Racine, Wisconsin 53404

(SUPER A) - FARMALL TRACTOR (1/47-12/53) > (238) - HYDRAULIC SYSTEM, TOUCH-CONTROL, PUMP > OIL SEAL

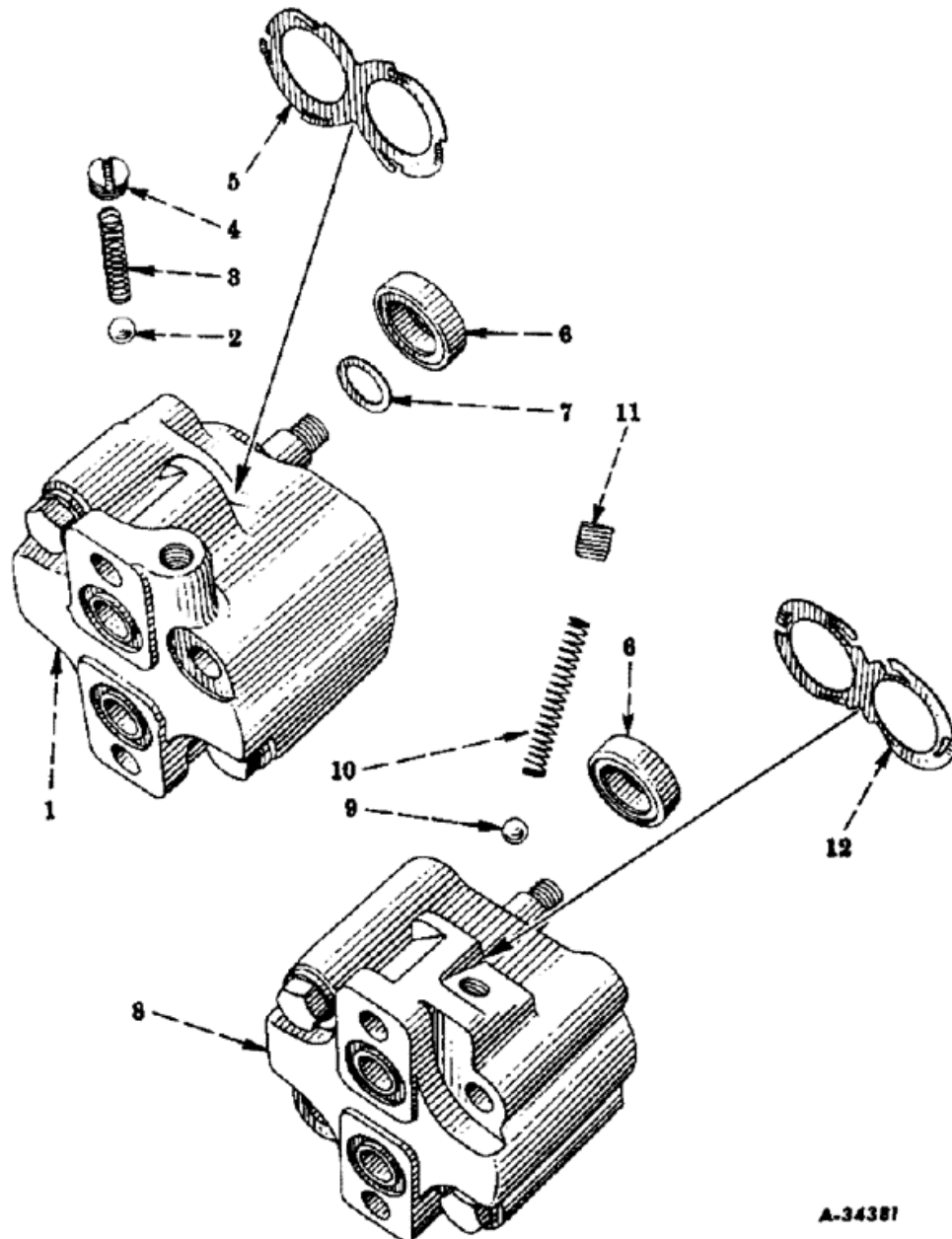

A-34381



PARTS & MERCHANDISE  
STORE

**Case IH Max Service** **621 State Street**  
**NACustomerRelations@caseih.com** **Racine, Wisconsin 53404**  
**877-422-7344 Option 1**

(SUPER A) - FARMALL TRACTOR (1/47-12/53) > (238) - HYDRAULIC SYSTEM, TOUCH-CONTROL, PUMP > OIL SEAL

Diag #	Part #	Name	Description	Qty
1	360689R91	PUMP	PUMP	1
		PUMP, touch-control, assembly (Pesco) (will work for 350707R96, 355007R94 and 355370R93) (optional with 360945R92) (composed of (1) ball 16008R1, (1) body, w/four bearings, two bolts, cover, two pump gears, and two washers (NSS), (1) oil seal 353183R91, (1) package 355362R91, (1) plug 361628R1, (1) ring 353186R1 (NSS), (2) ring 353203R11 (NSS), (1) screw 186282, (1) screw 179850, (1) spring 361625R1, (1) spring 361627R1, (2) washer, fibre 355202R1 (NSS)	PUMP, touch-control, assembly (Pesco) (will work for 350707R96, 355007R94 and 355370R93) (optional with 360945R92) (composed of (1) ball 16008R1, (1) body, w/four bearings, two bolts, cover, two pump gears, and two washers (NSS), (1) oil seal 353183R91, (1) package 355362R91, (1) plug 361628R1, (1) ring 353186R1 (NSS), (2) ring 353203R11 (NSS), (1) screw 186282, (1) screw 179850, (1) spring 361625R1, (1) spring 361627R1, (2) washer, fibre 355202R1 (NSS)	1
	114494	NUT,Jam, 3/8"-24, G5	NUT,Jam, 3/8"-24, G5	1
	179850	BOLT,Hex, 3/8" - 16 x 2 3/4", Gr 5	SCREW, cap, hex-hd., 3/8-16NC x 2-3/4", 2 used - 250001 to 342883	1
	186282	BOLT,Hex, 3/8" - 16 x 3 1/4", Gr 5	SCREW, cap, hex-hd., 3/8-16NC x 3-1/4", 342884 up	1
	103321	LOCK WASHER,3/8"	WASHER, LOCK, 3/8"	2
2	16008R91	BALL, chrome stl., 1/4" dia. (used only on Pesco pumps, 051012- 080-02 and 051012-081-02)	BALL, chrome stl., 1/4" dia. (used only on Pesco pumps, 051012- 080-02 and 051012-081-02)	1
3	361627R1		SPRING, ball check (used only on Pesco pumps, 051012-080-02 and 051012-081-02)	1
4	361628R1		PLUG, ball check (used only on Pesco pumps, 051012-080-02 and 051012-081-02)	1
5	361625R1		SPRING, bearing cover (used on all Pesco pumps)	1
6	353183R91	OIL SEAL	OIL SEAL, pump shaft (used only on Pesco pumps 051012-020-01, 051012-080-02, and 051012-081-02 and Thompson pumps) (optional with 362414R91)	1
6	362414R91	SEAL	OIL SEAL, pump shaft (used only on Pesco pumps, 051012-020-01, 051012-080-02 and 051012-081-02 and Thompson pumps) (optional with 353183R91)	1

Diag #	Part #	Name	Description	Qty
7	353836R1	RING	seal, pump shaft (used only on Pesco pumps 051012-020-02 thru 051012-020-07 and 051012-024-05 thru 051012-024-07)	1
8	360945R92	PUMP	PUMP	1
		PUMP, touch-control, assembly (Thompson) (will work for 360689R96, 355007R94, and 355370R93) (optional with 360689R91) (composed of - (1) ball 16009R1, (1) body, w/four bearings, two bolts, cover, and two pump gears (NSS), (1) oil seal 353183R91, (1) package 355362R91, (1) plug 361631R1, (1) ring (NSS) 352024R2, (1) ring (NSS) 356818R1, (2) screw 179851, (1) spring 361629R1, (1) spring 361630R1)	PUMP, touch-control, assembly (Thompson) (will work for 360689R96, 355007R94, and 355370R93) (optional with 360689R91) (composed of - (1) ball 16009R1, (1) body, w/four bearings, two bolts, cover, and two pump gears (NSS), (1) oil seal 353183R91, (1) package 355362R91, (1) plug 361631R1, (1) ring (NSS) 352024R2, (1) ring (NSS) 356818R1, (2) screw 179851, (1) spring 361629R1, (1) spring 361630R1)	1
	114494	NUT,Jam, 3/8"-24, G5	NUT,Jam, 3/8"-24, G5	1
	280161	BOLT,Hex, 3/8" - 16 x 3", Gr 5	BOLT,Hex, 3/8" - 16 x 3", Gr 5	2
	103321	LOCK WASHER,3/8"	WASHER, LOCK, 3/8"	2
9	16009R1	BALL	chrome stl., 9/32" dia., (used on Thompson pumps)	1
10	361630R1		SPRING, ball check (used on Thompson pumps)	1
11	361631R1		PLUG, ball check (used on Thompson pumps)	1
12	361629R1	SPRING	pressure plate (used on Thompson pumps)	1
	355207R91	GASKET	GASKET	1
		PACKAGE, manifold and pump seal ring and gasket (used on Pesco pumps 051012-020-01 thru 051012-020-07 and 051012-024-05 thru 051012-024-07) (consists of - (1) gasket 350706R2, (1) gasket 350708R1, (1) key 106749, (2) ring 350667R1, (2) ring (NSS) 353184R1, (1) ring (NSS) 353186R1, (1) ring (NSS) 353836R1, (2) ring (NSS) 355203R1, (1) seal (NSS) 353185R1, (2) washer (NSS) 355048R1, (2) washer (NSS) 355202R1)	PACKAGE, manifold and pump seal ring and gasket (used on Pesco pumps 051012-020-01 thru 051012-020-07 and 051012-024-05 thru 051012-024-07) (consists of - (1) gasket 350706R2, (1) gasket 350708R1, (1) key 106749, (2) ring 350667R1, (2) ring (NSS) 353184R1, (1) ring (NSS) 353186R1, (1) ring (NSS) 353836R1, (2) ring (NSS) 355203R1, (1) seal (NSS) 353185R1, (2) washer (NSS) 355048R1, (2) washer (NSS) 355202R1)	1

Diag #	Part #	Name	Description	Qty
	355362R91	PACKAGE	touch-control pump mounting gasket (composed of - (1) gasket 350706R2, (1) gasket 350708R1, (2) ring 350667R1)	1
	360691R91	STRIPPER PACKAGE	STRIPPER PACKAGE	1
		PACKAGE, manifold and pump seal ring and gasket (used only on Pesco pump 051012-080-02 and 051012-081-02) (composed of - (1) gasket 350706R2, (1) gasket 350708R1, (1) key 106749, (1) oil seal 353183R91, (2) ring 350667R1, (1) ring (NSS) 353186R1, (2) (NSS) 355203R1, (2) washer (NSS) 355202R1)	PACKAGE, manifold and pump seal ring and gasket (used only on Pesco pump 051012-080-02 and 051012-081-02) (composed of - (1) gasket 350706R2, (1) gasket 350708R1, (1) key 106749, (1) oil seal 353183R91, (2) ring 350667R1, (1) ring (NSS) 353186R1, (2) (NSS) 355203R1, (2) washer (NSS) 355202R1)	1
	360957R91	GASKET KIT	PACKAGE, manifold and pump seal ring and gasket (used only on Thompson pumps) (composed of - (1) gasket 350706R2, (1) gasket 350708R1, (1) key 106749, (1) oil seal 353183R91, (2) ring 350667R1, (1) ring (NSS) 352024R2, (1) ring (NSS) 356818R1)	1